

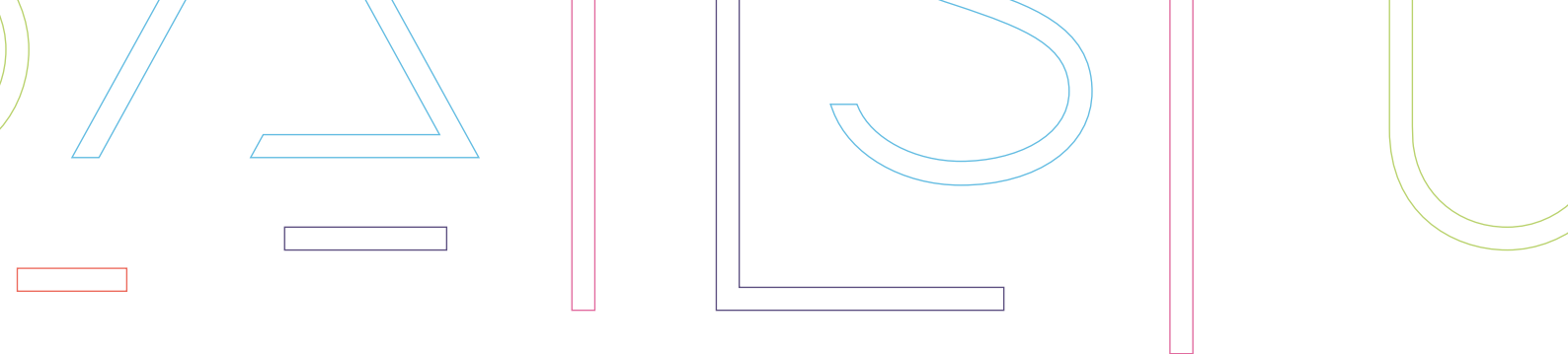

45th Annual Conference of the Psychological Society of Ireland

11th – 14th of November 2015
Radisson Blu Hotel & Spa, Galway





Wishing the PSI every success for the Conference 2015

www.shapebranding.ie

A 12 Seatown Business Campus,
Swords, Co. Dublin, K67 E670
T +353 1 840 6225
E info@shapebranding.ie

SHAPE

BRANDING + DESIGN

Contents

Conference highlights/ Registration desk opening hours	02
Welcome message from the PSI President	03
Welcome message from the Chair of the Conference Committee	04
Notes for the PSI Annual Conference	06
Keynote speakers	07
Main programme	09
Posters	21
List of delegates	22
Room and session allocation/ Hotel floor plan	24

Conference Highlights

Date	Time	Time
Wednesday 11th	10.00 – 16.00	Pre-conference workshop
	10.00 – 15.00	Student Research Seminar
	19.00 – 20.30	PSI NIBPS public lecture
	20.30	Signings of MoUs with BPS and APA
Thursday 12 th	14.15 – 15.00	Keynote address – Dr Niall Muldoon
	17.25 – 19.00	PSI AGM
	19.15 – 20.15	Play – My Name is Saoirse
	20.15 – 21.15	Buffet Dinner
Friday 13 th	12.00 – 13.20	PSI President's Address, followed by keynote address – Professor Kevin Nugent
	18.30 – 19.45	Poster viewing, wine and finger food reception
	21.30	SAG Annual Conference table quiz
Saturday 14 th	15.40 – 16.25	Keynote address – Mr Colm O'Gorman
	20.00	Annual gala dinner

Registration desk opening hours

The PSI Conference registration desk will be open during the times detailed below.

Thursday 12th: 09.45 – 17.00

Please note that registration for the PSI Annual General Meeting (AGM) will take place from 17.10 outside the AGM room (Inis Mor suite 2) and not at the PSI Conference registration desk.

Friday 13th: 08.45 – 17.00

Saturday 14th: 08.45 – 16.40

Welcome message from the PSI President

Dear friends and colleagues,

It is my great pleasure to welcome you to Galway for the PSI's 45th Annual Conference.

Galway is a great location to host our 45th Conference – it is steeped in the Arts and is a university city with a thriving school of psychology. Galway is known for conversation, for fun and creativity, and is the perfect hub for us to gather and enjoy the fantastic packed Conference schedule put together by the Scientific Affairs Board and the Conference Committee. These two groups have worked tirelessly all year to put together our Conference. The symposia, workshops, individual papers, and posters combine to reflect something of the variety, diversity and breadth of activity taking place in psychology in Ireland and beyond. They reflect the work of the psychologist in education, in practice and in research – reflecting psychology in all its glory.

The 2015 Conference provides a fantastic opportunity to catch up with old friends, meet new ones and get a real sense of what PSI has been advancing on your behalf over the last twelve months. Conference provides the opportunity to hear of the opportunities and challenges facing psychology both at local and global level.

I would like to draw your attention to a number of events over the next few days. We have three **keynote addresses**:

- Thursday - Dr Niall Muldoon presents *Bringing the rights of children closer to home – The Ombudsman for Children*, at 14.15;
- Friday – Dr Kevin Nugent presents *Towards science-based interventions in the first years of life – Supporting infant-parent mental health*, at 12.00;
- Saturday – Colm O’Gorman presents *The role of public discourse in shaping a human rights republic*, at 15.40.

Other significant highlights of the Conference include:

- Wednesday’s **pre-conference workshop**, *What’s compassion got to do with it? The role of self-compassion in clinical practice*, presented by Drs Louise Kinsella, Jennifer Gibson, and Katie Baird;
- The Student Affairs Group (SAG) **Student Research Showcase** which also takes place on Wednesday, from 10.00 – 15.00;

- The **joint PSI and NIBPS public lecture** being delivered by PSI member Dr Eddie Murphy. This takes place following the official opening of the Conference from 19.00 on Wednesday;
- The historic **signing of Memorandums of Understanding (MoUs)** between the PSI and the American Psychological Association (APA), and between the PSI and the British Psychological Society (BPS). The signing of both of these MoUs will take place on Wednesday from 20.30;
- The Society’s **Annual General Meeting (AGM)**, which will take place on the Thursday from 17.25, with delegates being able to register for the meeting from 17.10. It would be great to see as many members as possible at the AGM;
- The **PSI President’s Address** on Friday at 12.00 will be given by incoming President Dr Anne Davis.

Of particular note this year is the play – it will take place on Thursday night at 19.30. *My Name is Saoirse* will be performed by Sunday’s Child Theatre Company and is a one woman show which has received acclaimed reviews.

There are a number of social events arranged during the course of the Conference such as Thursday night’s buffet meal, Friday night’s wine and finger food reception and the Student Affairs Group (SAG) quiz, and of course the culmination of the Conference, Saturday night’s Annual Gala Dinner.

I would like to thank all those who have been responsible for organising this year’s Conference. I want to thank in particular our team from head office for pulling out all the stops! Special thanks in particular to Lisa Stafford – our PR and Events Manager. Without Lisa’s dedication and commitment this Conference simply would not be what it is.

I hope you have a really enjoyable PSI Conference. I hope it is nourishing for mind and spirit.

Kind and warm wishes,



Dr Paul D’Alton
PSI President

Welcome message from the Chair of the Conference Committee

Dear colleagues,

On behalf of the Conference Committee, I would like to welcome you to the Psychological Society of Ireland 45th Annual Conference 2015, in the Radisson Blu Hotel, Galway. The Annual Conference provides us with an opportunity to refresh ourselves on both a professional and personal level and also, as a psychological society, to reach out to the general public. We are very pleased to welcome you to a packed and exciting programme.

At the beginning of 2015, a new structure for the PSI Annual Conference Committee was approved, with the President Elect of the year taking on the role of Chair of the Committee. This new structure has worked very well over the past number of months. In taking up my role as PSI President during the Annual Conference, I will also be handing over the position of Chairperson of the Annual Conference Committee to the in-coming President Elect. I wish them the best of success for the 2016 PSI Annual Conference.

This year we have two pre-conference events. The first is a workshop, *"What's compassion got to do with it? The role of self-compassion in clinical practice"*, presented by Drs Louise Kinsella, Jennifer Gibson and Katie Baird. The second event is a **Student Research Seminar** hosted by the Student Affairs Group.

Following the official opening of the Conference on Wednesday evening by Dr Paul D'Alton, PSI President, the PSI and the NIBPS will again partner to present a free public lecture. This year Dr Eddie Murphy, probably best known for his role on RTÉ's Operation Transformation, will make a presentation entitled *'Becoming Your Real Self: By Transforming Stress, Depression and Anxiety into Hope and Freedom'*.

Wednesday evening events come to a close after the signing of a Memorandum of Understanding between PSI and the American Psychological Association and between the PSI and the British Psychological Society.

We would also like to remind you about the PSI Annual General Meeting and would encourage you to attend in order that you can be informed of the work that has been carried out on your behalf by Council. The AGM will take place on Thursday evening.

We are delighted to welcome our Keynote Speakers for this year: On Thursday afternoon we have Dr Niall Muldoon –Ombudsman for Children *"Bringing the rights of children closer to home – Ombudsman for Children"*. Following my Presidential Address on Friday, we then look forward to hearing from Dr Kevin Nugent, Director of the Brazelton Institute at the Boston Children's Hospital. The title of his address is *'Towards science-based interventions in the first years of life: Supporting infant-parent mental health'*. On Saturday afternoon we are pleased to welcome our final Keynote Speaker, Mr Colm O'Gorman, Executive Director of Amnesty International Ireland, who will deliver an address titled *"The Role of Public Discourse in Shaping a Human Rights Republic"*.

Of course at the heart of the Conference are the presentations by our colleagues which represent months or years of hard work. We would like to say thank you for your submissions as without these there would be no Conference. As in previous years, there will be five parallel sessions each day and these have been arranged thematically, so we are hopeful that those you are most interested in will be presented together. If you do find that you have to leave one session to attend another, please do so with as little disruption as possible. Additionally, the PSI Annual Conference poster round and exhibition viewing accompanied by a wine and finger food reception will take place in the conference foyer on Friday evening.

In the best traditions of the PSI Annual Conference, our time to socialise together is one of the highlights. This year we are delighted to welcome the Sunday's Child Theatre Company who will present their play 'My Name is Saoirse' on Thursday evening, which was presented at both the Edinburgh and Dublin Fringe Festivals. These are some of the reviews: the Irish Times said *"I laughed, I cringed, I cried – all in the space of an hour."* While the Irish Theatre Magazine said, *"Utterly fascinating"* and the Fringe Review called it *"Without flaw"*.

Following the serious business of Division and Special Interest Group meetings on Friday evening, the highly competitive (and usually quite hilarious) Student Affairs Group Table Quiz will take place. Our final gathering on Saturday evening is our annual Gala Dinner with music and dancing.

Needless to say, the Conference could not happen without impeccable organisation along with the hard work and dedication of many people. I would like to take this opportunity on behalf of the Conference Committee to thank Pat Holahan for his tireless work organising the Conference over many years and to say that he, along with his wife Sue, will be missed. Central to the organising team is Lisa Stafford, supported by Heather, Niamh, Olga, Gráinne and Loretta, our trusty staff from head office. Thank you also to the Conference Committee for their input into the many and varied issues that arise when organising an event of this nature. Thank you also to the Scientific Affairs Board headed by Dr Sean Hammond for their diligent and timely review of this year's submissions. To the Student Affairs Group under the leadership of Catherine Friend and Dean McDonnell who are taking care of all our technological needs throughout the Conference, we thank you.

We are also thankful to our sponsors and exhibitors who choose to support the PSI's flagship event each year. The 2015 Conference sponsors and exhibitors are – Brainworx, ETC Consult, Shape Branding, Ann Arbor Publishers, Houghton Mifflin Harcourt, PPS, Irish Pensions and Finance, Linton Instrumental, Selection by Design and Strive Clinic.

Finally, we hope that you enjoy the Conference and please feel free to ask for help or assistance should you need it.

Dr Anne Davis

On behalf of the Conference Committee

Conference Committee:

Dr Anne Davis;

Dr Michelle Coyle;

Dr Colm O'Tuathaigh;

Dr Sean Hammond;

Catherine Friend;

Lisa Stafford;

Heather Weight.

Notes for the PSI Annual Conference

Presenters

All **presenters of papers** are required to be present in the session room 10 minutes before the start of the session (where possible), and out of courtesy to fellow presenters, we ask that you attend for the full session. Early arrival is to allow time to load presentations on to audio visual devices and to confer with the Session Chair. If you are a speaker who intends to use PowerPoint in your presentation, you should note that you must load the file onto the relevant computer in the session room 10 minutes before the session begins. If you would like to use your own computer (and you are sure that no time will be lost), please inform the Conference Support Staff Member in your location.

In so far as possible, papers will be presented in the order given in the Conference programme and papers will adhere strictly to the agreed time schedule (usually twenty minutes per paper). Session Chairs will be firm, ensuring that presentations end at the agreed time. In the rare event of a presenter failing to turn up, Session Chairs will move immediately to the next listed presentation.

Presenters of posters, student and academic/ practitioner, are required to be at their poster during the poster round on Friday 13th from 18.30 – 19.45. Poster presenters are also welcome to be present at their posters during the breaks on Friday.

Workshops

Please note that there is a maximum attendance for each workshop. Information on the maximum attendance figure for each individual workshop is available from the Conference registration desk. If you wish to pre-register for any of the workshops please do so at the Conference registration desk.

Delegates

- **Sessions** are arranged thematically and delegates are encouraged to attend entire sessions rather than moving from one session to another. If it is necessary to leave a session before the end or arrive late at a session, please do so between, rather than during, papers and in a manner that causes as little disruption as possible.
- **Conference badges** should be worn at all times during the Conference. This is to ensure that we know that you have paid your registration fee and, therefore, can be allowed access to the lunch area and the buffet meal.

Continuing Professional Development

Attendance at the Conference and specific workshops confers Continuing Professional Development (CPD) credits. Therefore, please sign up for your CPD Credits at the Conference registration desk. Please note that daily attendance at the Conference earns 4 CPD credits per day. Additionally, attendance at individual workshops confers 2 CPD credits, with a maximum of 6 CPD credits per day. The pre-conference workshop is assigned 4 CPD credits.

Evaluation

We would love to hear what you thought of the 2015 PSI Annual Conference. Please visit our website www.psychologicalsociety.ie/conference and complete the online questionnaire. **This year all delegates who complete the online questionnaire before Monday 14th of December 2015 will be entered into a draw to win a voucher for two nights Bed & Breakfast with super buffet breakfast for two on each morning, at the Radisson Hotel and Spa, Galway!**

Return of Delegate Badges

The PSI will operate a delegate badge return system for all Conference delegates this year. A badge return box will be available at the Conference registration desk throughout the Conference.

Keynote Addresses

Thursday 12th November, 14.15

BRINGING THE OF RIGHTS CHILDREN CLOSER TO HOME - THE OMBUDSMAN FOR CHILDREN

Dr Niall Muldoon - Ombudsman for Children

As Ombudsman for Children, Niall often returns to the question posed by Eleanor Roosevelt in 1958: *"Where do human rights begin?"* Her answer remains compelling: *"In small places, close to home – so close and so small that they cannot be seen on any map of the world. Yet they are the world of the individual person: the neighbourhood he lives in; the school or college he attends; the factory, farm or office where he works... Unless these rights have meaning there, they have little meaning anywhere."* In a presentation to the UN Committee on the Rights of the Child in June 2015, Niall suggested the realisation of children's rights in Ireland is an unfinished project. The economic crisis that has beset Ireland for much of the past decade has had serious consequences for thousands of children. The most recent available data indicate 138,000 children are living in consistent poverty. A State that respects human rights is one that prioritises the human rights of its citizens, including children, in budgetary, legislative and administrative decision-making. Failings in this regard are evident in different areas of public administration concerning children where policy implementation has dominated over children's rights and best interests. This address will look at where progress has been made, what the challenges still are for Ireland's children and how it is essential to develop a culture of child-friendly public administration in Ireland where the rights and best interests of children are a primary consideration.



Biography

Dr Niall Muldoon is Ireland's second Ombudsman for Children. He was appointed to this position on February 17th 2015, by the Head of State, His Excellency, President Michael D. Higgins, following an open competition and interview process involving children and adults. As Ombudsman for Children, Dr Muldoon is directly accountable to the Houses of the Oireachtas.

In his previous role as Director of Investigations at the Ombudsman for Children's Office Niall oversaw the handling of almost 1600 complaints per year made by, or on behalf of, children and young people about public bodies such as the HSE, Tusla, Schools and Voluntary Hospitals. He ensured a culture of independence, impartiality and child centeredness underpinned the work at all times.

Niall is a Registered Counselling and Clinical Psychologist who has worked in the area of Child Protection for almost 20 years. Prior to joining the OCO in 2012, Niall spent five years as National Clinical Director of CARI – a Children's Charity providing therapy and support to children and families, from all over Ireland, affected by sexual abuse. He spent ten years working in the Granada Institute providing therapy, risk assessments and support to adults who had sexually offended against children and to those who had been abused as children. He was regularly called upon to provide expert testimony in the courts. Niall also worked within the field of Intellectual Disability for a number of years and indeed completed his Masters on the Development of a Relationship and Sexuality Programme for Adults with Intellectual Disability.

Friday 13th November, 12.00

TOWARDS SCIENCE-BASED INTERVENTIONS IN THE FIRST YEARS OF LIFE: SUPPORTING INFANT-PARENT MENTAL HEALTH

Dr J. Kevin Nugent - Director, Brazelton Institute, Division of Developmental Medicine, Boston Children's Hospital; Lecturer, Harvard Medical School; Professor Emeritus, University of Massachusetts at Amherst.

While basic clinical issues such as self-regulation, trust, attachment, autonomy and individuation are undoubtedly life course issues, the thrust of this presentation is that these issues are being actively negotiated by infants and parents from the very beginning. Advances in neuroscience and behavioral research reveal that the brain has the most plasticity during the early years, which means that it is a period of both vulnerability and opportunity. As such, this stage – beginning before birth – presents us, as psychologists, with a unique opportunity to affect change at what can be called a critical transition stage in brain development and in the development of emotional and physical health, social skills, and cognitive-linguistic capacities that are all important for success in school, the workplace, and in the larger community. This presentation will go on to describe an example of a developmentally supportive, relationship-based, strength-based approach to intervention, designed to improve the lives of young children and their families and hopefully benefit society as a whole.



Biography

Dr J. Kevin Nugent is Founder and Director of the Brazelton Institute at Boston Children's Hospital and is on the faculty at Harvard Medical School. He is also Professor Emeritus of Child and Family Studies at the University of Massachusetts at Amherst.

Professor Nugent received his early education in Ireland and graduated summa cum laude from Boston College in the United States with a degree in Philosophy. He received his doctorate in Developmental Psychology and has worked at the Boston Children's Hospital since 1978, conducting research on newborn behavior and early parent-infant relations and training professionals in neurobehavioral assessment and intervention techniques. Dr. Nugent's areas of research include the effects of different prenatal teratogens on developmental outcome, the transition to parenthood, the role of fathers and the effects of preventive intervention on parent-child relations and developmental outcomes. He has been co-investigator with Professor Sheila Greene at Trinity College, Dublin, in a longitudinal study of child development in Ireland and has also studied child development in different cultural settings across the world. Currently, he is conducting research on the effects of the NBO as a form of preventative intervention in both hospital and Early Intervention settings, with particular emphasis on its effects on postpartum depression and on parent-child relations.

Dr Nugent is the author of many books and book chapters and over 100 scientific articles on child behavior and development and on parent-child relationships. He is co-author with Dr. Brazelton of the Neonatal Behavioral Assessment Scale (NBAS), while he and his colleagues have developed the Newborn Behavioral Observations (NBO) system, a clinical tool used in pediatric and intervention settings to sensitize parents to the competencies and individuality of their infants and to foster positive parent-child relations. Among his books are the two-volume series, *The Cultural Context of Infancy* (1989, 1991), and *The Infant and Family in the 21st Century* (2002), of which he is co-editor with Joao Gomes-Pedro, Berry Brazelton and Jerry Young. *The Newborn as a Person: enabling healthy infant development worldwide* (2009) describes newborn research and practice in settings across the globe. In 2013, he completed a textbook for college students, *Development of Children and Adolescents* with Penny Hauser-Cram, Kathleen Thies and John F. Travers and published by Wiley and Sons. In 2011, with photographer Abelardo Morell, Dr. Nugent wrote *Your Baby is speaking to You: A Visual Guide to the Amazing Behaviors of Your Newborn and Growing Baby*, a book for new parents. He is currently studying the historical context of the infant mental health movement and is editing a book on the uses of the NBO in parent-infant mental health settings around the world.

Saturday 14th November, 15.40

THE ROLE OF PUBLIC DISCOURSE IN SHAPING A HUMAN RIGHTS REPUBLIC

Colm O'Gorman - Executive Director of Amnesty International Ireland

In May this year, Ireland became the first country in the world to enshrine marriage equality for same sex couples in law by popular ballot. One of the most striking aspects of the referendum campaign was the quality of public debate.

It demonstrated that Irish society is more than capable of having an engaged, objective but passionate conversation on a social issue that many believed would be deeply divisive.

Colm will explore what this means for further developments in the area of human rights and equality in Ireland with a focus on the issue of sexual and reproductive rights and the role that public discourse has in realising the vision of a republic of equals enshrined in the Proclamation of Independence.



Biography

Colm O'Gorman is the founder and former Director of One in Four, the national non-governmental organisation that supports women and men who have experienced sexual violence.

In this role Colm was instrumental in the establishment of the Ferns Inquiry, the first state investigation into clerical sexual abuse. Prior to his role with One in Four Colm worked as a psychotherapist in his own practice in London.

Colm has also served as a member of the Irish Senate, having been appointed as a Senator in May 2007. He is a regular media commentator and contributor, essayist and the author of the best-selling memoir, 'Beyond Belief'.

Colm's work as a human rights defender is driven by a deep commitment to human rights and social justice and an abiding belief in the power of advocacy and activism, which challenges all of us to use our individual and collective voices to demand and work for change where it is most needed.

Main Conference Programme

Wednesday 11 November 2015

09.30 – 10.00 Pre-conference workshop registration - Conference Foyer	
<p>10.00 – 16.00 Pre-conference workshop - Veranda Lounge What's compassion got to do with it? The role of self-compassion in clinical practice Presented by Drs Katie Baird, Louise Kinsella and Jennifer Gibson</p>	<p>10.00 - 15.00 SAG Student Research Showcase Inis Mór Suite 1</p>
<p>19.00 Official opening of the Conference followed by the PSI NIBPS public lecture - Inis Mór Suite 1 Becoming Your Real Self: By Transforming Stress, Depression and Anxiety into Hope & Freedom presented by Dr Eddie Murphy</p>	
<p>20.30 - Inis Mór 3 Signing of the PSI & BPS Memorandum of Understanding (MoU) , Signing of the PSI & APA Memorandum of Understanding (MoU)</p>	

Thursday 12th November 2015

09.45 – 17.00 Delegate registration in the Conference Foyer				
10.00 – 10.30 Tea/coffee & exhibition viewing in Conference Foyer				
Session A	Session B	Session C	Session D	Session E
10.30 – 12.30	10.30 – 12.30	10.30 – 12.30	10.30 – 12.30	10.30 – 12.30
Chair: Brendan Rooney	Chair: Ken O'Reilly	Chair: Ronan Conway	Chair: Brendan O'Connell	Workshop
Symposium Something a little more creative: Exploring the nature of creativity	Symposium Cognitive impairment in schizophrenia in a secure forensic setting	Symposium Out the gap! Seasoned clinicians topping up on doctoral research in NUI Galway	Individual presentations	Fergal Rooney
Arlene Egan, Rebecca Maguire, Grace O'Malley & Philip Hyland	Danny O'Sullivan, Ken O'Reilly, Ciarán Coyle, Gary Donohoe et al.	Ann McCarty, Ronan Conway & John Bogue	Garry Prentice & Keith Schofield	'I don't go into sex' – Building comfort and skill in working with clients' psychosexual needs
Thinking creatively: Is there a relationship between creativity and thinking styles?	Prospective cohort study of the relationship between neurocognition, social cognition and violence in forensic patients with schizophrenia and schizoaffective disorder	Experiences of recovery in a rehabilitation mental health service: The perspective of the family	Emotional labour and motivational factor impact on academic employee pride, work commitment and organisational citizenship	
Katarzyna Rejkiewicz, Ellen Brady & Brendan Rooney	Danny O'Sullivan, Ken O'Reilly, Ciarán Coyle, Gary Donohoe et al.	Ruth Yoder, Caroline Heary, Pdraig McNeela & Ronan Conway	Frédérique Vallières, Eilish McAuliffe, Philip Hyland, Ilias Mahmud et al.	
Creativity among video game players: A qualitative approach	A cross-sectional study of the association between cognition and symptomatic remission in forensic patients with schizophrenia	How do individuals develop alcohol use disorder after bariatric surgery? A grounded theory exploration	Cross-cultural development and validation of the perceived supervision scale: A study of community health workers	
Arlene Egan, Rebecca Maguire & Brendan Rooney	Danny O'Sullivan, Ken O'Reilly, Ciarán Coyle, Gary Donohoe et al.	Anne Marie Regan, Ronan Conway & Molly Byrne	Nuala Whelan, Sinead McGilloway & Mary P. Murphy	
Exploring children's perception of creativity using the Draw-Write-Tell technique	The impact of cognitive problems on psychosocial treatment for forensic patients with schizophrenia or schizoaffective disorder: a prospective study	Validation of situational judgement tests in GP selection	Perceived effectiveness of Ireland's labour market policy: Emerging themes and lessons	
Rebecca Maguire, Arlene Egan & Phil Maguire	Ciaran Coyle, Ken O'Reilly, Danny O'Sullivan, Gary O'Donohue et al.	Elizabeth Nolan, Ronan Conway & Brian McGuire	Julie McCafferty, Nuala Whelan & Mick Creedon	
Creativity: Breaking or bending the rules?	A randomised controlled trial of cognitive remediation within a secure forensic setting	The psychological impact of paediatric liver disease	Ballymun Youth Guarantee Scheme Pilot: An interagency approach to labour activation	
	Ken O'Reilly, Danny O'Sullivan, Ciarán Coyle, Gary Donohoe et al.	Ursula Bates, Ronan Conway & Brian McGuire	Christine Corrigan & Inge Nieuwstraten	
		Becoming aware: A qualitative study of palliative care patient's experience of an individual mindfulness based stress reduction program	How do executive coaches encourage a coachee to take action and flourish?	
		Eamon Smith, Ronan Conway & John Bogue	Mark Kelly & Alison Dillon	
		Early maladaptive schemas and schema modes: Measurement and meaning	Examining the effectiveness of Smartphone applications at reducing levels of stress	

Thursday 12th November 2015

Session A	Session B	Session C	Session D	Session E
12.35 – 13.35	12.35 – 13.35	12.35 – 13.35	12.35 – 13.35	12.35 – 13.35
<p>Symposium Emotional suffering or psychopathology; Responding to the emotional pain at the core of client presentations</p> <p>Chair: Katarina Timulakova</p> <p>Daragh Keogh, Ladislav Timulak, James McElvaney, Siobhan McNally et al.</p> <p>Transforming core emotional pain in Emotion-Focused Therapy treatments for depression and anxiety; A metasynthesis of four single case-studies</p> <p>Katarina Timulakova & Yasmin Khan</p> <p>Relationship between emotional pain and psychopathology in mental health service users</p> <p>Laura Carey, Mary Creaner & Katarina Timulakova</p> <p>The shame experiences of individuals with social anxiety</p>	<p>Individual presentations</p> <p>Chair: Colm O’Tuathaigh</p> <p>Lucie Corcoran, Patricia Frazer & Conor McGuckin</p> <p>Navigating today’s ‘wild west’: How primary school children engage with the Internet and cope with online risk</p> <p>Lynn Farrell, Andy Cochrane & Louise McHugh</p> <p>Exploring attitudes towards gender and science: The advantages of an IRAP approach versus the IAT</p> <p>Simon Farrell & Ian Grey</p> <p>An investigation into the barriers and enablers of evidence-based psychological practice (EBPP) for practicing psychologists in Ireland</p>	<p>Individual presentations</p> <p>Chair: Margaret O’Rourke</p> <p>Mike Murphy, Katie Spillane, James Cully, Esperanza Navarro-Pardo et al.</p> <p>Word puzzles and verbal fluency: Does task specificity matter?</p> <p>Edward O’Carroll, Conall Tunney & Brendan Rooney</p> <p>Testing feelings of immersion and attention between 2D and 3D film</p> <p>Pauline M. Cogan</p> <p>Introducing TEST2r for reading and writing</p>	<p>Workshop</p> <p>Marie Walsh, Geraldine Cregg & Ailise Burke</p> <p>An evaluation of the Stay Safe, Personal Development and Relationships (SSPDR) training programme for adults with intellectual disability, high support and complex needs</p>	
<p>13.35 – 14.15</p> <p>Lunch: Soup & sandwiches Tea/coffee</p> <p>Marinas Restaurant</p>				
<p>14.15 – 15.00</p> <p>Keynote Address</p> <p>Dr Niall Muldoon Ombudsman for Children</p> <p><i>Bringing the rights of children closer to home - The Ombudsman for Children</i></p> <p>Session Room A (Inis Mór Suite 1)</p>				

Thursday 12th November 2015

Session A	Session B	Session C	Session D	Session E
15.00 – 17.00	15.00 – 17.00	15.00 – 17.00	15.00 – 17.00	15.00 – 17.00
<p>Symposium Psychotherapy research: Therapeutic ruptures, impact of bullying, pivotal moments, and integration</p> <p>Chair: Rosaleen McElvaney</p> <p>Gerard Meehan & Rosaleen McElvaney</p> <p>Recent graduates' reported experience of therapeutic ruptures during psychotherapy training</p> <p>Catherine Whelan, Rosaleen McElvaney & Melissa Corbally</p> <p>Childhood history of bullying and third level counselling</p> <p>Nicky O'Leary</p> <p>Pivotal moments in therapy</p> <p>Rosaleen McElvaney, Evelyn Gordon & Mimi Tatlow Golden</p> <p>Experiences of integration in psychotherapy training: Trainee perspectives</p>	<p>Symposium Life-course adversity, trauma & attachment issues in vulnerable populations</p> <p>Chair: Barbara Hannigan</p> <p>Mairead Murray, Barbara Hannigan & Timothy Trimble</p> <p>Client completed suicide in Ireland: The professional and personal Impact on the therapist and therapists' experience of suicide postvention</p> <p>Lia Gallagher & Barbara Hannigan</p> <p>Highs, lows and lessons learned: Exploring the emotions of the first year of motherhood with care leavers; An adapted life story approach</p> <p>Clodagh Jordan & Barbara Hannigan</p> <p>The perceived psychological and emotional impact of adoption on the adopted individual</p> <p>Patrick Hallinan & Barbara Hannigan</p> <p>The relationship between PTSD, attachment and emotion regulation in a homeless population</p>	<p>Individual presentations</p> <p>Chair: Anne Marie Regan</p> <p>Grainne H. Kirwan</p> <p>Emotional, tentative and causation language use in online pregnancy loss boards</p> <p>Philip Hyland, Maj Hansen, Cherie Armour, Mark Shevlin et al.</p> <p>Understanding the nature of PTSD: An empirical comparison of the DSM-5 and ICD-11 models of PTSD</p> <p>Diarmuid MacGarry, Barbara Von Mensenkampff, Isabella Touhy & Mark O'Sullivan</p> <p>Acquired Brain Injury in Ireland: Investigating the characteristics of psychology service users</p> <p>Karen Kinsella, Barbara Von Mensenkampff & Marcia Ward</p> <p>An evaluation of a fatigue management intervention for Headway Acquired Brain Injury (Ireland): An exploratory study</p> <p>Emma Hurley & Raegan Murphy</p> <p>A dynamic assessment approach to evidence-based psycho-educational learning support: Results from two pilot studies</p>	<p>Workshop</p> <p>Davina Walsh & Siobhan Ni Coitir</p> <p>Group therapy for sex offenders: Why bother?</p>	<p>Workshop</p> <p>John Helminski</p> <p>Evaluating and managing risk for violence in the mentally ill patient</p>
<p>17.00 – 17.25 Tea/coffee & exhibition viewing Conference Foyer</p>				
<p>17.25 – 19.00 PSI AGM (Registration from 17.10 outside AGM room) Session Room B (Inis Mór Suite 2)</p>				
<p>19.15 – 20.15 <i>My Name is Saoirse</i> Play performed by Sunday's Child Theatre Company Inis Mór Suite 1</p>				
<p>20.15 – 21.15 Dinner: Buffet Marinas Restaurant</p>				

Friday 13th November 2014

08.45 – 17.00 Delegate registration continues in the Conference Foyer				
Session A	Session B	Session C	Session D	Session E
09.15 – 10.35	09.15 – 10.35	09.15 – 10.35	09.15 – 10.35	09.15 – 10.35
<p>Symposium “Hush little baby don’t you cry” Listening to the voice of the baby in Irish health services</p> <p>Chair: Aoife Menton</p> <p>Aoife Menton & Barbara Dooley</p> <p>Exploring the factors contributing to perinatal mental health and infant bonding among pregnant women in Ireland</p> <p>Helen Shanley</p> <p>The French working model of perinatal psychology</p> <p>Marian O’Flynn</p> <p>A reflective ante-natal course to support infant mental health</p> <p>Catherine Maguire & Nicola Lally</p> <p>IMH assessment, intervention, consultation, and reflective practice supervision in North Cork Primary Care Psychology Child & Family Service- Progress to date</p>	<p>Symposium Changing healthcare professionals’ behaviour</p> <p>Chair: Gerry Molloy</p> <p>L. Mellon</p> <p>The delivery of smoking cessation advice to hospitalised smokers: A two-hospital survey</p> <p>G. J Molloy</p> <p>General practitioners support of adherence to and uptake of prescription contraception: An exploratory study</p> <p>M. Byrne</p> <p>From evidence base to intervention specification: Example of a sexual counselling intervention in cardiac rehabilitation</p> <p>L. Hynes</p> <p>Service providers’ perspectives on hospital clinic attendance rates among young adults with type 1 diabetes</p>	<p>Individual presentations</p> <p>Chair: Aisling White</p> <p>Kate Gajewska, Vincent McDarby, Colin Patrick Hawkes & Declan Cody</p> <p>Fear of hypoglycaemia in parents of children with type 1 diabetes and its effect on parental stress</p> <p>Aidan McKiernan, Lynsey O’Keeffe, Clare Quinn, Ellen Butler et al.</p> <p>Experience of respite services at LauraLynn Ireland’s Children’s Hospice, family functioning and parental coping</p> <p>Caroline Bergin-McLoughlin & David Hevey</p> <p>Maintaining wellness in Fibromyalgia</p> <p>Fionna McDarby, Molly Byrne & Denis O’Hora</p> <p>Taking the sweetness out of the ‘Share a Coke’ marketing campaign: The influence of personalisation on children’s drink choices</p>	<p>Individual presentations</p> <p>Chair: Melrona Kirrane</p> <p>Eileen Dukes & Barry Coughlan</p> <p>Towards a psychosocial theory of ageing with lifelong intellectual disability</p> <p>Ailish Mc Garry, Suzanne Guerin, Orla Murray, Teresa Gadd et al.</p> <p>Supporting the transition to adulthood in intellectual disability: Applying a psychological framework</p> <p>Jenny Gavin</p> <p>Exploring the perspectives of frontline staff on the Health Information and Quality Authority standards in the context of intellectual disability on the community setting</p> <p>Robert Coen, Deirdre A. Robertson, Rose Anne Kenny & Bellinda L. King-Kallimantis</p> <p>Strengths and limitations of the widely used Montreal Cognitive Assessment (MoCA)</p>	<p>Workshop</p> <p>Paula Dunne, Bridget Egan, Margaret Grogan & Dorothy Holland</p> <p>Student well-being and mental health promotion: Support for schools in their work with students</p>

Friday 13th November 2014

10.35 – 11.00 Tea/coffee & exhibition viewing - Conference Foyer				
Session A	Session B	Session C	Session D	Session E
11.00 – 12.00	11.00 – 12.00	11.00 – 12.00	11.00 – 12.00	11.00 – 12.00
<p>Symposium Towards a model of service for children with acquired brain injury</p> <p>Chair: Brian McClean</p> <p>Sarah Casey, Lorraine Crawley & Caroline McGrath</p> <p>Towards a model of service for children with acquired brain injury</p> <p>Brian McClean</p> <p>The journey starts when you leave hospital. A case study</p> <p>Brian Waldron</p> <p>Community-based paediatric ABI rehabilitation intervention. A case study</p>	<p>Individual presentations</p> <p>Chair: Margaret O'Rourke</p> <p>Conor McGuckin & Aoife M. O'Brien</p> <p>Bereavement in the classroom: How do educators support grieving students?</p> <p>Sally Flynn & Kiran Sarma</p> <p>What is the real relationship between Facebook use and depression? A systematic review of the literature</p> <p>Pam Pennings O'Connor & Raegan Murphy</p> <p>Does diet matter? Investigating the relationship between nutrition and academic performance in a sample of Irish 15 to 17 year olds</p>	<p>Individual presentations</p> <p>Chair: Brendan O'Connell</p> <p>Emma Hurley, Raegan Murphy, Rob King, Amanda Roberts et al.</p> <p>Men's sexual risk-taking and life history strategy</p> <p>Ben Hughes</p> <p>Predisposing influences associated with compulsive sexual behaviour</p> <p>David McIlroy & Sabrina Hazari</p> <p>Non-intellectual associates of grade points average and teachers' predicted grades in secondary level students</p>	<p>Individual presentations</p> <p>Chair: Colm O'Tuathaigh</p> <p>Siobhan Nic Fhlannchadha & Tina Hickey</p> <p>Tús maith leath na h-oibre? Are first language speakers of Irish getting the support they need?</p> <p>Sinead D'Arcy-Bewick & Mark Elliott</p> <p>The golden section in auditory cognition</p> <p>William Wilkinson & Zane Wilkinson</p> <p>WIAT - II reading speed: A preliminary validity study</p>	
<p>12.00 – 13.20</p> <p>PSI President's Address followed by Keynote Speaker Address</p> <p>PSI President's Address</p> <p>Dr Anne Davis</p> <p>Keynote Address</p> <p>Dr J. Kevin Nugent</p> <p>Director, Brazelton Institute, Division of Developmental Medicine, Boston Children's Hospital; Lecturer, Harvard Medical School; Professor Emeritus, University of Massachusetts at Amherst.</p> <p><i>Towards science-based interventions in the first years of life: Supporting infant-parent mental health</i></p> <p>Session Room A (Inis Mór Suite 1)</p>				
<p>13.20 – 14.05</p> <p>Lunch: Main course, Tea/coffee - Marinas Restaurant</p>				

Friday 13th November 2014

Session A	Session B	Session C	Session D	Session E
14.05 – 16.05	14.05 – 16.05	14.05 – 16.05	14.05 – 16.05	14.05 – 16.05
<p>Symposium Educational psychology; New Research (Part 1)</p> <p>Chair: William Kinsella</p> <p>Bridget Finnegan & Niamh Flynn</p> <p>Self-regulated learning, working memory and academic achievement in Irish second-level students</p> <p>Emma Harkin & Sheena Burke Examining the effects of a six-week mindfulness programme with young children on their executive functioning and emotional and psychological well-being</p> <p>Suzanne Wall & Dymrna Devine An investigation into teenage boys' social networking site use</p> <p>Sarah O'Hanrahan, Declan Fahie & Triona Byrne An examination of cyberbullying within child and adolescent mental health services in Ireland</p> <p>Sheena Morrissey & William Kinsella A study into extended school non-attendance in Irish post-primary schools</p>	<p>Symposium Rethinking standard models of psychopathology: Where to next?</p> <p>Chair: Jamie Murphy</p> <p>Philip Hyland, Jamie Murphy, Mark Shevlin, Steven Carey et al.</p> <p>Identification of a common psychological factor across various axis-I psychiatric disorders</p> <p>Eoin McElroy, Mark Shevlin & Jamie Murphy Psychosis: Categorical disorders or a single continuum?</p> <p>Gary Adamson, Orla McBride & Martina Casey Unpacking heterogeneity: Identifying potential sources of bias in the measurement of alcohol use disorder</p> <p>Mark Shevlin Diagnostic independence: Testing the robustness of the diagnostic boundary between PTSD and psychosis</p> <p>Jamie Murphy, Seamus Fleming & Mark Shevlin A person-centered approach to understanding co-morbidity among psychiatric disorders</p>	<p>Symposium Neuropsychology in Pre-neurosurgical evaluation: Practicalities and challenges of WADA testing</p> <p>Chair: Diane Gillan</p> <p>Mark Mulrooney WADA testing - WADYA know</p> <p>Ruth Buckmaster, Mark Mulrooney, Donncha O'Brien & Niall Pender Neuropsychology stat!! Responding urgently to critical care patients</p> <p>Niamh Doyle, Mark Mulrooney, Tom Burke & Niall Pender Clinical predictors of Wada outcome among temporal lobe epilepsy patients</p> <p>Sarah Clarke, Niall Pender & Mark Mulrooney Wada test: Patient experience of brief hemispheric anaesthesia</p> <p>Niall Pender, Tom Burke, Sarah Clarke & Mark Mulrooney Recognition memory in epilepsy: What can the Wada test tell us about memory consolidation?</p>	<p>Workshop</p> <p>Pat Dawson & Marian Quinn Parenting in prison: An innovative partnership across the prison walls</p>	<p>Workshop</p> <p>Mark Smyth & Vincent McDarby #WeneedtotalkaboutSocialMedia: Medium or menace? What psychologists should know</p> <p>Presented by the Communications Subgroup of PSI Council</p>
16.05 – 16.30				
Tea/coffee & exhibition viewing - Conference Foyer				

Friday 13th November 2014

Session A	Session B	Session C	Session D	Session E
16.30 – 18.30	16.30 – 18.30	16.30 – 18.30	16.30 – 18.30	16.30 – 18.30
Symposium Educational psychology: New research (Part 2)	Symposium Diversity in a community forensic setting	Symposium Early career psychologists' research in an acute hospital setting	Individual Presentations	Workshop
Chair: Kevin Keane	Chair: Patrick Randall	Chair: Niall Pender	Chair: Vincent McDarby	Aisling Curtin, Paul D'Alton & Geraldine Moane
Roisín Watson & Gráinne Ní Dhomhnaill	Richie Dooley	Marta Pinto-Grau, Tom Burke, Katie Loneragan, Marwa Elamin et al.	Suzanne Egan & Jennifer Pope	Mindfulness and acceptance for gender and sexual minorities: Contextual strategies to foster self-compassion, connection, and equality
Learning to socialise: An intervention programme with children attending preschool in a disadvantaged area	Positive behavioural support for a residential client with complex needs	A prospective population-based study of language changes in ALS	The effect of childcare on the cognitive and socio-emotional development of infants	
Fiona Larkin & Gráinne Ní Dhomhnaill	Rioghnaigh O'Leary	Katie Loneragan, Tom Burke, Marwa Elamin, Marta Pinto-Grau et al.	Ruth Melia	
Facilitators and barriers to participation in home, school and community settings by children with physical disabilities - Parent and teacher perspectives	Group therapy for sex offenders in a community based forensic setting	Phenotypic differences on measures of visuospatial function in ALS: An encoding, consolidation and retrieval paradigm	An evaluation of the "Parent's Plus: Parenting When Separated" intervention within a primary care child psychology service Aileen O'Reilly	
Dearbhla Crowley & Joyce Senior	Ruth Groarke	Tom Burke, Marwa Elamin, Katie Loneragan, Marta Pinto-Grau et al.	Going to school - A child's transition from pre-school to primary school	
Teachers' awareness of and attitudes towards students with epilepsy	Understanding adolescent criminal offending via their unmet childhood needs	Assessing the functional equivalence of verbal and spatial working memory tasks in Amyotrophic Lateral Sclerosis	Pam Pennings O'Connor & Raegan Murphy	
Sarah McManus & Sheena Burke	Jeanine De Volder	Alice Stanton, Eamon Dolan, Niamh Moran, David Williams et al.	The creation and validation of the nutrition and dietary patterns questionnaire	
Creating a niche for educational psychology in further/ higher education in Ireland: A qualitative study using a grounded theory approach	Assessing risk of non-accidental injury: A minefield?	Can an enriched diet improve cognition?: A double blind, randomised, controlled study	Suzanne Egan & Aisling Murray	
			The effect of television watching on the socio-emotional development of young children	
			Karen Stack, Raegan Murphy, Paula Prendeville & Maria O'Halloran	
			WISC-IVUK cognitive profiles of children with Autism Spectrum Disorder (ASD)	
18.30 – 19.45				
PSI Annual Conference poster round and exhibition viewing				
Reception: Wine & finger food				
Conference Foyer				
At 18.45 Emily Cahill, winner of the PSI Special Award at the 2015 BT Young Scientist and Technology Exhibition, will undertake a short presentation on her winning project – 'An investigation into the influence of gender equality education on the attitudes of children towards gender roles in the workforce'				

Friday 13th November 2014

19.45		
Meetings of Divisions and Special Interest Groups (SIGs)		
Time	Meeting	Room
7.45pm – 9.15pm	Division of Clinical Psychology AGM Session B Room	Session B Room (Inis Mór Suite B)
7.45pm – 8.45pm	Division of Forensic Psychology Meeting	Session D Room (Veranda Lounge)
7.45pm – 9.30pm	Division of Neuropsychology AGM	Session E Room (Morris Suite)
7.45pm – 8.45pm	Sexual Diversity and Gender Issues Special Interest Group AGM	Joyce Suite (beside Session Room E – Morris Suite)
7.45pm – 8.45pm	Perinatal and Infant Mental Health Special Interest Group General Meeting (open to all PSI members)	Marina's Private Section (off the main restaurant)
7.45pm – 9.15pm	Division of Educational Psychology Meeting	Session A Room (Inis Mór Suite A)
7.45pm – 8.45pm	Division of Teachers and Researchers Committee Meeting	D'arcy Suite (opposite PSI registration desk)
21.30		
SAG quiz – Veranda Lounge		

Saturday 14th November 2014

08.45 – 16.40 Delegate registration continues in the Conference Foyer				
Session A	Session B	Session C	Session D	Session E
09.00 – 11.00	09.00 – 11.00	09.00 – 11.00	09.00 – 11.00	09.00 – 11.00
<p>Symposium Critical role of psychology in medical settings: Psychological needs of physically ill patients</p> <p>Chair: Jennifer Wilson-O' Raghallaigh</p> <p>Diane Gillan, Siobhan McHale & Niall Pender</p> <p>A pilot of the Distress Thermometer among renal patients on dialysis</p> <p>Oleksandr Boychak, Victoria Lunt & Mary Keating</p> <p>Role of psychology in acute hospital care supporting patients with a diagnosis of Ductal Carcinoma in Situ (DCIS)</p> <p>Eleanor Moran, Jennifer Wilson-O'Raghallaigh, Lucy Power, Muireann Roche et al.</p> <p>"With your skin in mind" - Pilot psychodermatology clinic in an acute hospital setting</p> <p>Marese Heffernan, Jennifer Wilson-O'Raghallaigh, Marelise Spies, Mary Forry et al.</p> <p>"Not just a disease with a pair of legs": Exploring participant and peer leader experiences of the chronic disease self-management programme</p>	<p>Symposium Dialectic Behavioural Therapy for an intellectual disability population: Planning, delivery and evaluation</p> <p>Chair: Mary Davis</p> <p>Mary Davis, Sean Conneally & Ann Loughney</p> <p>An interagency and systemic approach to the introduction of Dialectical Behaviour Therapy (DBT) within an Intellectual Disability (ID) Service</p> <p>Hazel Moore, Geraldine Cregg & Haulie Dowd</p> <p>Delivering Dialectical Behaviour Therapy to an Intellectual Disability population: Process and challenges</p> <p>Haulie Dowd, Hazel Moore & Geraldine Cregg</p> <p>Comprehensive Dialectical Behaviour Therapy intervention for an Intellectual Disability service: Changes in target behaviours in six single-case designs</p> <p>Geraldine Cregg, Haulie Dowd & Hazel Moore</p> <p>The application of Dialectical Behaviour Therapy (DBT) for para-suicidal behaviour in an individual with a mild Intellectual Disability in an Irish disability service: A case study</p>	<p>Individual presentations</p> <p>Chair: Malie Coyne</p> <p>Martina Raftery, Kate Burke, Natalie Murray & Orla O'Duinn</p> <p>An intensive personalised support approach to treating individuals with psychosis and co-morbid mild intellectual disability: A clinical and cost effective study</p> <p>Ellen Butler, Reena Thomas & Trudie Chalder</p> <p>A systematic review and qualitative analysis of anxiety among MS patients</p> <p>Sophia Keane</p> <p>Exploring relationships between attachment styles, fear of intimacy, and differentiation of self among clients in residential treatment centres, and the impact these have on the therapeutic alliance</p> <p>Sarah Brunkard, Michael Byrne & Kiran Sarma</p> <p>The development and evaluation of a group-based stress management program for adults</p> <p>Karen Keogh, Richard Booth, Katie Baird, Jennifer Gibson et al.</p> <p>A Radically Open-Dialectical Behaviour Therapy (RO-DBT) informed group intervention for over-control: A controlled trial with 3-month follow-up</p> <p>Sally Flynn, Eoin Ryan & Sinead Conneely</p> <p>Evaluating the effectiveness of a low-intensity, psycho-educational intervention (Stress Control) in reducing psychological distress and perceived stress in a community sample</p>	<p>Individual presentations</p> <p>Chair: Michele Coyle</p> <p>Susan O'Flanagan, Sinead Conneely, Louise Kinsella, Paul D'Alton et al.</p> <p>Body image and psychological distress in a sample of women with breast cancer: The mediating role of self-compassion</p> <p>Niall Galligan, David Hevey, Robert Coen & Joseph Harbison</p> <p>Fatigue and psychological distress post-stroke: The role of anxiety-related factors and positive coping resources</p> <p>Alanna Donnelly & Barbara Dooley</p> <p>What works & what doesn't work in mental health services for the transitional adolescent age group? Learning from a pilot Irish CAMHS for 16-18 year olds</p> <p>Paula Hurley, Sara McDevitt, Caitriona O'Malley & Siobhan O'Neill</p> <p>"What do you think? Parents journey through Child and Adolescent Mental Health Services (CAMHS)": A focus group for parents of young people attending a specialist community CAMHS</p> <p>Sarah-Jane Winders, Anita Hyland & Damien Connolly</p> <p>Examining the development and evaluation of a support group for siblings of children on the autism spectrum</p>	<p>Workshop</p> <p>Mariah Curtin & Lorraine Crawley</p> <p>Goal directed skills training: An executive function intervention for Adults with an ABI</p>

Saturday 14th November 2014

11.00 – 11.30 Tea/coffee & exhibition viewing Conference Foyer				
Session A	Session B	Session C	Session D	Session E
<p>11.30 – 13.20</p> <p>Symposium Learning and assessment in education: Implications for practice</p> <p>Chair: Claire Griffin</p> <p>Elaine Ahern & Claire Griffin Learning by teaching: Is it worth the effort?</p> <p>Aoife Cassidy & Anne Cleary Should I record my guess to a pre-test?</p> <p>Laura McNamara & Marie Ryan Exploring stereotype threat in the administration order of standardised reading and mathematics assessments</p> <p>Rachel Stokes & Suzanne Parkinson The scarlet letter: Is the use of red pen in academic feedback as harmful as initially suggested?</p>	<p>11.30 – 13.20</p> <p>Symposium Emotion-focused therapy</p> <p>Chair: Ladislav Timulak</p> <p>Sean O'Connell, Ladislav Timulak, Natalie Hession & Allison Connolly Self-critic transformation in comorbid anxiety and depression: A case study of Emotion Focused Therapy with a cancer patient</p> <p>Nora O'Keeffe, Katherine O'Brien, Ladislav Timulak & James McElvaney Emotion-focused case conceptualisation of Generalised Anxiety Disorder: Core emotion schemes in Generalised Anxiety Disorder</p> <p>Anne McQuaid, Lucy Rowell, Jennifer Murphy, Ladislav Timulak et al. Working with worry in EFT for GAD: Developing a model of EFT for worry</p> <p>Richard Meacham, Ladislav Timulak, Samantha Hughes & James McElvaney Transforming emotional injury with a developmentally significant other through a series of unfinished business dialogues in clients with Generalised Anxiety Disorder: A task analytic approach</p>	<p>11.30 – 13.20</p> <p>Individual presentations</p> <p>Chair: Suzanne Guerin</p> <p>Pam Pennings O'Connor & Raegan Murphy Do healthy behaviours matter? Investigating the relationship between healthy behaviours and fluid intelligence</p> <p>Brian Harrington & Michael O'Connell Video game use and prosocial behaviour: The relationship between prosocial video game use, empathy and prosocial behaviour in Irish children and adolescents</p> <p>Lucia Prihodova, Suzanne Guerin & W. George Kernohan Development of a model of knowledge transfer for use in applied health settings: Results from a systematic scoping review</p> <p>Paula Prendeville, Thomas O'Mahony, Mary-Kate Burke & Alice Cashman The views and experiences of children with High Functioning Autism (HFA), and parents, regarding second language acquisition: An Irish educational context</p> <p>Conor McGuckin, Elizabeth M. Welch, Michelle J. Bartlett & Aoife M. O'Brien BubbleSkool: A 'creative and imaginative' approach to aiding the education of children with rare diseases</p>	<p>11.30 – 13.20</p> <p>Individual presentations</p> <p>Chair: Vincent McDarby</p> <p>Lucie Corcoran & Conor McGuckin New wine, old bottles? Time to rethink cyberbullying intervention approaches</p> <p>Carol Murphy & Pdraig MacNeela The association between short-term and long-term self-regulation, risky sexual behaviours and alcohol in college students</p> <p>Eimer Cadogan, Karen O'Leary & Samantha Dockray The effects of a gratitude intervention on physiological and self-report wellbeing</p> <p>Rachel Kenny, Barbara Dooley & Amanda Fitzgerald Using mobile technology to promote positive mental health in adolescents</p> <p>Kevin Treacy, Gerard Molloy & Kiran Sarma Loneliness and paracetamol use: A cross-sectional study</p>	<p>11.30 – 13.20</p> <p>Individual presentation & Workshop</p> <p>Trauma Psychology</p> <p>Individual presentation</p> <p>Brid Keenan Trauma memory in the time of the Peace Process</p> <p>Workshop</p> <p>Nikki Kiyimba, Tom Dalton & Paula Roseingrave When the professional becomes personal</p>
<p>13.20 – 14.00 Lunch: Soup and sandwiches Tea/coffee Marinas Restaurant</p>				

Saturday 14th November 2014

Session A	Session B	Session C	Session D	Session E
14.00 – 15.40	14.00 – 15.40	14.00 – 15.40	14.00 – 15.40	14.00 – 15.40
<p>Symposium Research in applied settings</p> <p>Chair: Sinead Meade</p> <p>Suzanne Guerin, Peter Hanlon & Gemma Kiernan Exploring the potential contribution of a therapeutic recreation-based bereavement programme for families who have lost a child to serious illness</p> <p>Emma Nicholson, Suzanne Guerin, Fiona Keogh & Philip Dodd An evaluation of novel and innovative respite services in Intellectual Disability services in Ireland</p> <p>Orla Walsh & John Kane Nurturing resilience in early childhood care and education practice</p> <p>Holly Corboy, Alison McGourty & Matteo Cella Investigating the feasibility and acceptability of Cognitive Remediation Therapy on inpatients with treatment-resistant psychosis</p>	<p>Individual presentations</p> <p>Chair: Aisling White</p> <p>Sarah-Jane Winders A conceptual analysis of positive indicators of addiction treatment efficacy</p> <p>Maria Dempsey, Moya Clancy & Sara Dunne Living with depression: Intimate partners perspectives on depression</p> <p>Marie Walsh How does 'meaning making' contribute to post traumatic growth in women in remission from cancer?</p> <p>Katie Grogan, Marie Naughton, Clare O'Toole & Jessica Bramham Overlapping symptoms in ADHD and anxiety rating scales</p> <p>Laura O'Halloran, Robert Whelan & Emily Jollans Neuropsychosocial predictors of successful nicotine abstinence</p>	<p>Individual presentations</p> <p>Chair: Ian O'Grady</p> <p>Lynsey O'Keeffe, Gillian O'Brien & Aileen O'Reilly Emerging evidence for Jigsaw: a youth mental health service for 12-25 year olds</p> <p>Clíodhna O'Connor & Amanda Fitzgerald Psychometric evaluation of the social anxiety scale for adolescents</p> <p>Eamonn Barron, Sandra Fox & Joanne Lambe Evaluation of HAIL regional visiting support service: Preventing homelessness, supporting mental health</p> <p>Brid Anne Davis, Mas Mohamad, Maeve Leonard, Karen Ryan et al. Under the neuropsychological microscope: An investigation of the prevalence of delirium and/ or other cognitive issues within a palliative care population - preliminary findings</p>	<p>Individual presentations</p> <p>Chair: Philippa Coughlan</p> <p>Stephen Quigley, SORCHA Connellan, Alana Ward & Barry Linnane False-positive newborn screening for cystic fibrosis; Parents distress and knowledge deficiencies</p> <p>Patrick Murphy & David Hevey The HIV Revelation Model: Predicting the disclosure of HIV seropositivity during casual sex encounters between men who have sex with men</p> <p>Jessica Russell-Carroll & Michael Gordon An examination of relational patterns in adolescents with and without emotional dysregulation and their parents through a cognitive analytic lens</p> <p>Alanna Donnelly, Paul D'Alton, Louise Kinsella, Giuseppe Gullo et al. Self-compassion, attachment & psychological well being: The case for psoriasis patients</p> <p>Conor McGuckin, Elizabeth M. Welch, Michelle J. Bartlett, Aoife M. O'Brien et al. 22q: What's that then? A psycho-educational view of rare diseases</p>	<p>Workshop</p> <p>Robert Coen, Garret McDermott, Simone Carton, Suvi Dockree et al. Division of Neuropsychology Assessment Workshop</p>
<p>15.40 – 16.25 Keynote Address Mr Colm O' Gorman Executive Director, Amnesty International Ireland <i>The Role of Public Discourse in Shaping a Human Rights Republic</i> Session Room A (Inis Mór Suite 1)</p>				
<p>16.25 – 16.40 Tea/coffee Conference Foyer</p>				

Saturday 14th November 2014

Session A	Session B	Session C	Session D	Session E
16.40 – 18.20	16.40 – 18.20	16.40 – 18.20	16.40 – 18.40	16.40 – 18.40
<p>Symposium The Irish Hospital Psychologists Group: Exploring recent developments in our understanding and clinical practice</p> <p>Chair: Katie O'Brien</p> <p>Natalie Hession, Lauren Deimling Johns & Allison Connolly</p> <p>Young peoples' experience of cancer: What are their needs?</p> <p>Allison Connolly, Natalie Hession & Lauren Deimling Johns</p> <p>Emerging issues among young adult cancer survivors: One size does not fit all</p> <p>Orla McArdle, Victoria Lunt & Michelle Gibbons</p> <p>Better health, better living in women survivors of breast cancer- A pilot study</p> <p>Rosemary Walsh</p> <p>Neuropathic pain is different: Improving hospital-based psychological treatments utilizing a tailored approach</p> <p>Noreen Gilhooly & Valleri Switzer</p> <p>Exploring the effectiveness of a group intervention in patients recovering from cancer</p>	<p>Individual presentations</p> <p>Chair: TBC</p> <p>Veronica Byrne, Deirdre Murphy & Kiran Sarma</p> <p>Decision making ability and Intellectual Disability: Exploring the awareness and experience of staff who work directly with people we support</p> <p>Mary Carton, Patrick Ryan & Declan McLoughlin</p> <p>An exploratory study of autobiographical memory specificity and cognitive avoidance in non-affective psychosis</p> <p>Lasairiona McGuinness, Patrick Ryan, Elizabeth Lawlor, Robert Jones et al.</p> <p>Siblings' lived experience of their relationship with their brother or sister presenting with First-Episode Psychosis (FEP)</p> <p>Roisin Curtin & Edel Crehan</p> <p>Evaluation of an emotion regulation skills group intervention for people recovering with psychosis: A pilot study</p> <p>Paula Hurley, Claire O'Sullivan & Donnacha O'Donovan</p> <p>The lived experience of people with obsessive-compulsive disorder attending a community based support group</p>	<p>Individual presentations</p> <p>Chair: Paul Hogan</p> <p>Martina Carroll</p> <p>Women's stories of family and community through the lens of a psychological analysis</p> <p>Claire Hayes</p> <p>The results of a randomised control trial highlights the effectiveness of Aware's online CBT programme for helping people with depression</p> <p>Maria Dempsey, Sara Dunne & Moya Clancy</p> <p>'Put your own oxygen mask on first': Learnings from long term partners of people who cope with depression</p> <p>Mike Murphy, Grace O'Regan, Esperanza Navarro Pardo & Juan José Fernández Muñoz</p> <p>Socioemotional selectivity and an Eriksonian prism: Emotional support and depression across the lifespan</p> <p>Alanna Donnelly, Barbara Dooley & Amanda Fitzgerald</p> <p>The Revised Child Anxiety & Depression Scale (RCADS): Is it valid for use with Irish adolescents?</p>	<p>Workshop</p> <p>Patrick Randall</p> <p>Projective assessment techniques: The science and the tea leaves</p>	<p>Workshop</p> <p>Aisling Curtin</p> <p>The ACT matrix- Setting a context for values-guided therapy</p>

18.40

Meeting of Division

Time	Meeting	Room
18.40 - 20.00	Division of Counselling Psychology	Session E Room (Morris Suite)

20.00

Annual PSI Gala Dinner, followed by music and dancing
The Inis Mór Ballroom

Poster Presentations

In so far as possible, the PSI would appreciate posters being on display for the duration of the Conference. However, all posters MUST be displayed from 09.00 – 19.45 on Friday 13th of November. The poster judging round will take place from 18.30 – 19.45.

ACADEMIC/ PRACTITIONER POSTERS

1. Relationships between the burden experienced by caregivers and the degree of relatedness with the dependent family member - Andrea Vázquez-Martínez, Esperanza Navarro-Pardo, Noelia Flores-Robaina, Natalia Fernández Pintos et al.
2. Wii fit for the elderly: Health improvement through exercise videogames - Natalia Fernández Pintos, Esperanza Navarro-Pardo, Andrea Vázquez-Martínez & Mike Murphy.
3. The techniques for overcoming depression scale: Mokken analysis and concurrent validity - Frank Doyle, Kenneth E. Freedland, Mariantonia Lemos, Brian C. Steinmeyer et al.
4. Using the “Active Recruitment” process: Adults with intellectual disabilities have their say on mental health and social participation - Emmeline Gillan, Jennifer Holloway & Inam Ulhaq.
5. A comparison of psychological and medical indices pre and post bariatric surgery - Amy-Rose Hayes, Gillian Moore-Groarke & Colm O’Boyle.
6. Individual Quality of Life in ALS, change over time? – Caoifa Madden, Miriam Galvin, Iain Mays, Rebecca Gaffney et al.
7. A Population based Analysis of Palliative Needs, Services and Outcomes in Amyotrophic Lateral Sclerosis – Iain Mays, Miriam Galvin, Rebecca Gaffney, Caoifa Madden et al.
8. Understanding the journey to ALS diagnosis - A Caregiver’s perspective – Rebecca Gaffney, Miriam Galvin, Caoifa Madden, Iain Mays, et al.
9. Acquired Brain Injury-Family education workshops: Evaluation of participant feedback - Diarmuid MacGarry, Barbara Von Mensenkampff, Isabella Touhy & Mark O’Sullivan.
10. Clinical psychologists experience integrating psychotherapy training into clinical practice - What can we learn - Clotilde O’Keeffe Lyons.
11. “The world that I knew had gone”: A grounded theory study on the impact of father loss on women bereaved as adolescents - Inge Nieuwstraten.
12. Assisting on the journey through third level education: An exploration of an academic and well-being support service - Suzanne McCarthy.
13. The effect of controllability and causality on blame assignment - Suzanne Egan & Caren Frosch.
14. Use these digital readiness/preparation tools to support your new flexible learners! - James Brunton, Mark Brown, Eamon Costello, Lorraine Delaney et al.
15. The programme-level, strategic design and development of undergraduate psychology assessments - James Brunton & Elaine Walsh.

STUDENT POSTERS

16. Stability and predictors of well-being over time - Niamh McGrath, Karen O’Leary & Samantha Dockray.
17. WEIS-ing up to self-directed weight stigma; Internalised weight bias and body size estimation accuracy - Niamh McGrath, Samantha Dockray & Eimer Cadogan.
18. Exploring the role of achievement motivation and problem-solving style in educational success - Richard Gamble, Tony Cassidy, Marian McLaughlin & Melanie Giles.
19. Discursive exploration of how foreign affair officials negotiate their meaning of immigration in Ireland - Karen Kinsella & Lisa Scott.
20. An interpretive phenomenological analysis of assembly cells and their relationship with employee engagement - Kevin Silke & David Biggs.
21. A constructivist grounded theory exploration of the concept of ‘coaching maturity’ - Orla Killeen & Inge Nieuwstraten.
22. Benefits and stressors associated with the pre-doctoral year as an Assistant Psychologist - Rachel O’Meara.
23. Impact of vicarious trauma on a sample of lawyer and community mediators: An interpretative phenomenological study - Aoife Fennelly & Jean Quigley.
24. Say my name: the healing journey. Mothers’ experience of adaptation to the stillbirth loss of their baby - Mairead Brennan, Padraig Macneela and Helen Grealley.
25. Evaluating the effectiveness of the Friends For Life Programme in responding to childhood anxiety in an Irish primary care clinic setting - Aoife Martin & Suzanne Carroll.
26. “Like they say the devil makes time for idle hands, I think it’s the same with idle minds”. A grounded theory exploration of unemployment and young unemployed Irish males’ attitudes towards help-seeking - Jason Courtney & Inge Nieuwstraten.
27. Exploring the recovery process during suicide intervention therapy - Hilary Groarke, Paul Surgenor & Marelise Spies.
28. Exploring young Irish males’ perception of coaching as a help service option: A qualitative research study - Katie Smith & Inge Nieuwstraten.

List of Delegates *(as of 27/10/2015)*

Surname	First Name	Surname	First Name	Surname	First Name
Ahern	Elaine	Crudden	Charlotte	Hanrahan	Josephine
Armstrong	Máire	Cunningham	Sharon	Harkin	Emma
Barron	Eamonn	Curtin	Aisling	Harrington	Brian
Bates	Ursula	Curtin	Mariah	Hayes	Amy-Rose
Bergin	Caroline	Curtin	Roisin	Hayes	Claire
Bergin McLoughlin	Caroline	D'Alton	Paul	Healy	Denis
Bishop	Rosalind	D'Arcy-Bewick	Sinead	Heffernan	Marese
Blau	Isolde	Davenport	John	Hegarty	Patrick
Bogue	John	Davis	Anne	Helmski	John
Boyle	Deirdre	Davis	Brid	Hernon	Barbara
Brandsma	Lotte	Davis	Mary	Hickey	Deirdre
Branney	Peter	Dawson	Pat	Hogan	Paul
Brennan	John	Dempsey	Maria	Holahan	Patrick
Brennan	Mairead	Dillon	Alison	Holland	Dorothy
Broderick	John	Donnelly	Alanna	Hughes	Ben
Brown	Ken	Dooley	Richie	Hughes	Brenda
Brunkard	Sarah	Dowd	Michael	Hurley	Emma
Brunton	James	Doyle	Frank	Hurley	Paula
Buckmaster	Ruth	Doyle	Niamh	Hyland	Philip
Burke	Ailise	Drumm	Michael	Hynes	Lisa
Burke	Eimear	Duggan	Sinead	Irwin	Brenda
Burke	Sheena	Dukes	Eileen	Irwin	Lynn
Burke	Tom	Dunne	Paula	Jordan	Clodagh
Butler	Ellen	Egan	Arlene	Joyce	Edward
Butler	Majella	Egan	Bridget	Kambamettu	Clare
Byrne	Hollie	Egan	Suzanne	Keane	Kevin
Byrne	Molly	Elmer	Nicola	Keating	Mary
Byrne	Veronica	Faherty	John	Kelly	Mark
Byrnes	Eric	Farrell	Lynn	Kelly	Yvonne
Cadogan	Eimer	Farrell	Simon	Kennedy	Brid
Caramlau	Isabela	Fennelly	Aoife	Kenny	Rachel
Carey	Laura	Finnegan	Bridget	Keogh	Daragh
Carroll	Martina	Flanagan	Jacqueline	Keogh	Karen
Carton	Mary	Flanagan	Rachel	Kerr	Robert
Cassells	Ciara	Fleming	Mitchel	Kidd	Nick
Cassidy	Aoife	Flynn	Sally	Kinsella	Karen
Clarke	Peter	Gaffney	Megan	Kinsella	William
Clarke	Sarah	Gaffney	Rebecca	Kirrane	Melrona
Coen	Robert	Gajewska	Kate	Kirwan	Grainne
Coffey	Anne-Marie	Gallagher	Laura	Kiyimba	Nikki
Cogan	Pauline	Gallagher	Lia	Larkin	Fiona
Conlon	Andrea	Gallen	Martin	Lawless	Angela
Connell	Clare	Galligan	Niall	Leahy	Marie
Connery	Virge	Gamble	Richard	Levy	Hadas
Conroy	Colette	Gavin	Jenny	Liddy	Barbara
Conway	Ronan	Gibney	Ronan	Likely	Noreen
Corboy	Holly	Gillan	Diane	Linehan	Elmarie
Coughlan	Gillian	Griffin	Claire	Lonergan	Katie
Coughlan	Philippa	Groarke	Hilary	Lunt	Victoria
Coyle	Ciarán	Groarke	Ruth	MacGarry	Diarmuid
Coyle	Michele	Grogan	Katie	Maguire	Rebecca
Coyne	Malie	Grosu	Alvina	Maher	Eleanor
Crawley	Lorraine	Guerin	Suzanne	Maher	Joan
Cregg	Geraldine	Hacker Hughes	Jamie	Maher	Majella
Crowe	Barbara	Hallinan	Patrick	Maher	Laura
Crowley	Dearbhla	Hannan	Niamh	Malone	Janet
Crowley	Peadar	Hannigan	Barbara	Marren	Colm

Surname	First Name	Surname	First Name	Surname	First Name
Martin	Elaine	Murray	Mairead	Prosser	Ann
Martin	Aoife	Murray	Marie	Quigley	Stephen
Martin	Caroline	Newell	Anna	Quinn	Marian
Mays	Iain	Nic Fhlannchadha	Siobhan	Raftery	Martina
McCabe-Strange	Jean	Nicholson	Emma	Ranaghan	Michele
McCafferty	Julie	Nieuwstraten	Inge	Randall	Patrick
McCarthy	Ann	Nolan	Elizabeth	Ronayne	James
McCarthy	Odhran	Nolan	Jenny	Rooney	Brendan
McCarthy	Suzanne	Nugent	Kevin	Rooney	Fergal
McCaughey	Patsy	O'Brien	Gillian	Roseingrave	Paula
McComish	Jacinta	O'Brien	Katherine	Russell-Carroll	Jessica
McCullagh	Emmeline	O'Callaghan	Dermot	Ryan	Christian
McDarby	Fionna	O'Connell	Brendan	Serb	Leigh-Anne
McDarby	Vincent	O'Connell	Sean	Shanahan	Richard
McDermott	Garret	O'Connor	Anne	Sheridan	Audrey
McElroy	Eoin	O'Connor	Cliodhna	Silke	Kevin
McElvaney	Rosaleen	O'Connor	Cormac	Smith	Eamon
McGinley	Margaret	O'Connor	Maebh	Smyth	John
McGovern	Hugh	O'Dea	Theresa	Smyth	Mairead
McGrath	Niamh	O'Donnell	Erika	Smyth	Mark
McGuckin	Conor	O'Donovan	Cliodhna	Stack	Karen
McGuinness	Carol	O'Donovan	Fiona	Stiobhairt	Antaine
McGuinness	Lasairiona	O'Dwyer	Denise	Stokes	Denise Margaret
McIlroy	David	O'Flanagan	Isobel	Swain	Ronny
McKeever	Paul	O'Flanagan	Susan	Swan	Ethna
McKiernan	Aidan	O'Flynn	Marian	Szydowska-Micyk	Gosia
McLoone	James	O'Gorman	Colm	Takkash	Laila
McManus	Sara	O'Grady	Ian	Thompson	Julianne
McNamara	Laura	O'Halloran	Laura	Timoney	Patricia
McPeake	Kay	O'Hanlon	David	Timulakova	Katarina
McQuaid	Anne	O'Hanrahan	Sarah	Toolan	Rochelle
Meacham	Richard	O'Keefe	Lynsey	Traynor	Angeline
Meade	Sinead	O'Keefe	Nora	Treacy	Kevin
Meehan	Gerard	O'Keefe Lyons	Clotilde	Tunney	Conall
Melia	Ruth	O'Leary	Margaret	Tuohy	Isabella
Menton	Aoife	O'Leary	Nicky	Tynan	Trish
Mernagh	Marion	O'Leary	Rioghnaich	Ui Chonail	Eithne
Millane	Thomas	O'Mahony	Thomas	Vickers	Marian
Molloy	Gerard	O'Malley	Caitriona	Vigano	Noemi
Moloney	Edel	O'Malley	Conor	Von Mensenkampff	Barbara
Monaghan	Marian	O'Meara	Rachel	Waldmann	Thomas
Moore	Hazel	O'Neill	Stephen	Waldron	Brian
Moran	Eleanor	O'Reilly	Aileen	Wall	Marianne
Morrissey	Sheena	O'Reilly	Ken William	Wall	Suzanne
Muldoon	Niall	O'Rourke	Margaret	Walsh	Davina
Mulhern	Gerry	O'Sullivan	Danny	Walsh	Marie
Mullane	Mary	O'Toole	Emma	Walsh	Orla
Mullock	Emma	Owens	Sheena	Walsh	Rosemary
Mulrooney	Mark	Pearson	Corinne	Watson	Roisin
Murphy	Carol	Pender	Niall	Whelan	Catherine
Murphy	Eddie	Pennings O'Connor	Pam	Whelan	Nuala
Murphy	Mike	Phillips	Mary	White	Aisling
Murphy	Norma Jean	Pilch	Monika	Wilkinson	William K
Murphy	Patrick	Pinto-Grau	Marta	Wilson O'Raghallaigh	Jennifer
Murphy	Paul	Prendeville	Paula	Winders	Sarah-Jane
Murray	Aisling	Prentice	Garry	Wynne	Ciara
Murray	Lisa	Prihodova	Lucia	Yoder	Ruth

Room and session allocation / Hotel floor plan

Session	Room(s)
A	Inis Mór (Suite A)
B	Inis Mór (Suite B)
C	Inis Mór (Suite C)
D	Veranda Lounge
E	Morris Suite

Please note for certain meetings the following rooms will also be used – **Joyce Suite, Marinas Private Section, D’arcy Suite.**

The PSI Media Room will be located in the **Athy Suite**

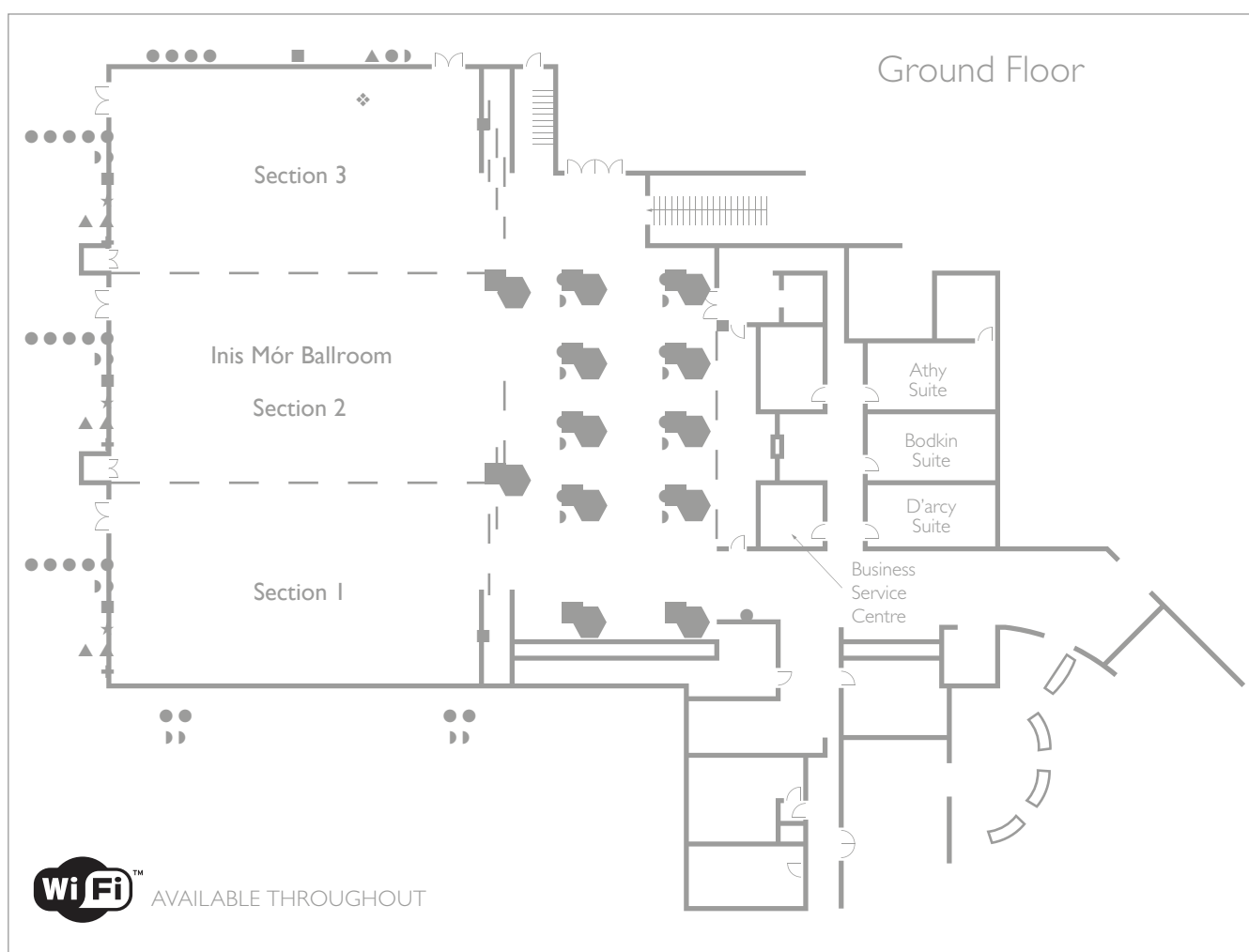

The Inis Mór sections, the Athy, Bodkin and D’arcy Suites, and the Veranda Lounge are all located on the ground floor of the Radisson, with the Veranda Lounge being located off the main hotel reception area. The Marinas Private Section is located off the main restaurant, also on the ground floor.

The Morris and Joyce Suites are located upstairs, directly above the main reception.



Selection by Design Occupational Testing Specialists

Since 2009, providing PSI members with:

- EFPA/BPS accredited training in Psychometric Testing (PSI-approved CPD)
- Ability, Personality and Career Interest testing services
- Psychometric instrument sales
- Test-specific training
- Career and employment consultation

Contact us to find out more!

www.selectionxdesign.com

info@selectionxdesign.com

+353 (0)86 3927638

SxD

Selection by Design

“Choosing Employees, Building Careers”

Psychological Health in Ireland

PSI's Strategic Plan 2014-2017, Pillar 4, includes both advancing psychology in the public interest and promoting health, wellbeing and resilience in Ireland. **Psychological Health in Ireland (PHI)** is a pillar 4 initiative. **PHI** is a campaign focusing on providing the public with evidence based information and resources for mental health, wellbeing and resilience. **PHI** also aims to showcase the value of psychologists and to convey the value of psychological science and practice to “improve everyday life.”

PHI will provide a comprehensive series of evidence based, multi-media education programmes designed to provide teaching and learning in important health, wellbeing and resilience skills. It is planned that the PSI will provide a series of psychological science to society resources and events on the topic **Psychological Health** during the course of 2016. Presentations will be provided free to the public around Ireland and made available to the wider public via the PSI website, social and wider media.

We would like to get valuable opinions from members of the PSI to inform this initiative, and would appreciate greatly if Conference attendees could complete the short survey which is available in your conference packs. Completed surveys can be returned to the PSI Conference registration desk, or alternatively can be returned by post to the PSI office.

Would you or any psychologist on your team like to be involved with the PHI campaign?
Please let us have your contact details and let us know you would like to be involved.

Thank you for your input.

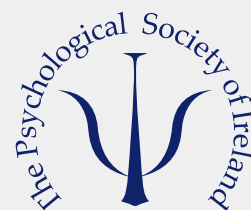

Cumann Síceolaithe Éireann

Exhibitors and Sponsors

**ann arbor
publishers**

www.annarbor.co.uk

Brainworx

www.brainworx.ie

ETC Consult
Make the Right Move

www.etcconsult.com

**Houghton
Mifflin
Harcourt**

www.hmhco.com

ipf
Irish Pensions & Finance

www.ipf.ie

linton

www.lintoninst.co.uk

PPS

www.ppstrust.org

Radisson BLU
HOTEL & SPA. GALWAY

www.radissonhotelgalway.com

SxD
Selection by Design

www.selectionxdesign.com

SHAPE
BRANDING + DESIGN

www.shapebranding.ie

strive
CLINIC

www.striveclinic.ie

SAVE THE DATE

46th PSI Annual Conference, 9th – 12th November 2016, Sheraton Athlone



Cumann Síceolaithe Éireann

2nd Floor, Grantham House, Grantham Street, Dublin 2, Ireland

Telephone: + 353 1 472 0105

www.psihq.ie